

Waterlase *express*[™]



BIOLASE

Quick Start Guide

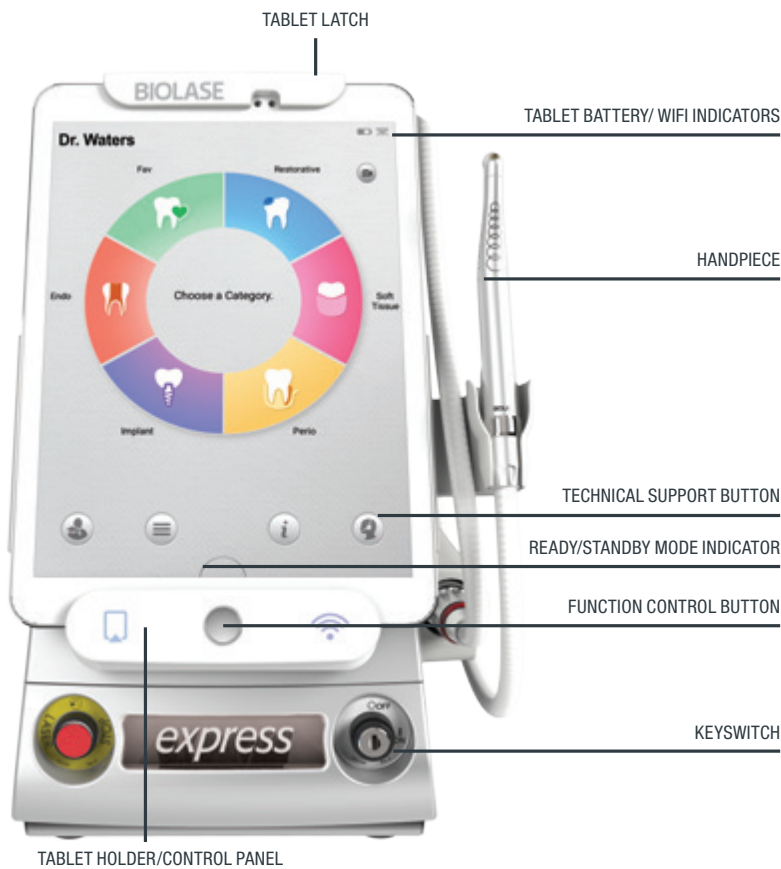

Figure 1

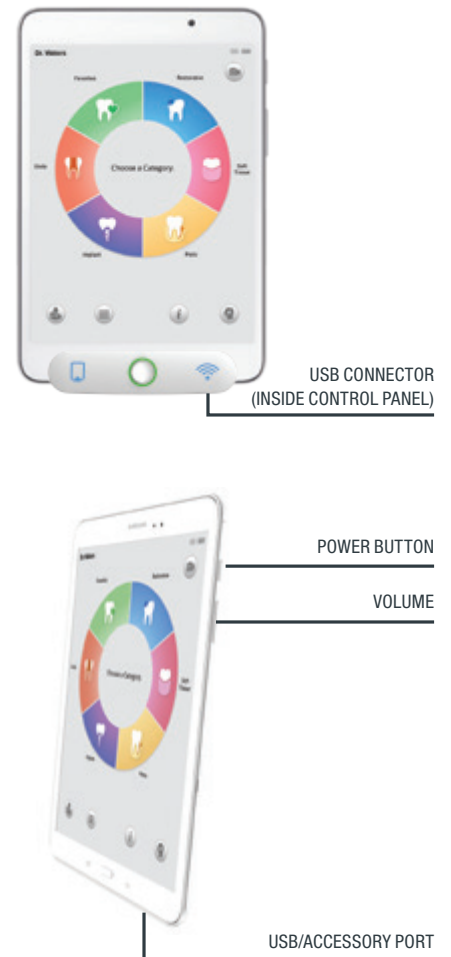

Figure 2

INSTALLING THE TABLET

The Tablet is attached to the console by a USB connector incorporated inside the bottom of the Control Panel. Slide the Tablet from the top down into the Control Panel and lock it in place by flipping the upper latch over the Tablet; when the system is ON, the LED indicator on the front of the Tablet Holder will light up when the Tablet is properly connected and active.

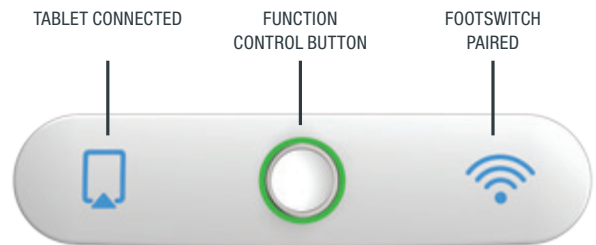

Figure 3

The Tablet's battery is fully charged prior to shipment. However, if it does not turn on when the power button on the side of the Tablet is pressed, remove the tablet from the Tablet Holder and use the USB cable provided to charge the Tablet; charging should take no more than 15 minutes. Refer to Section 7 of the User Manual for detailed instructions.

The Tablet automatically charges when it is installed in the Tablet Holder and the laser system is plugged in and ON. The Tablet will not charge when the laser system is OFF. If the laser system is off for any length of time, the tablet may need to be charged prior to use.

SYSTEM COMPONENTS

The Waterlase Express all-tissue laser system includes the following system components:

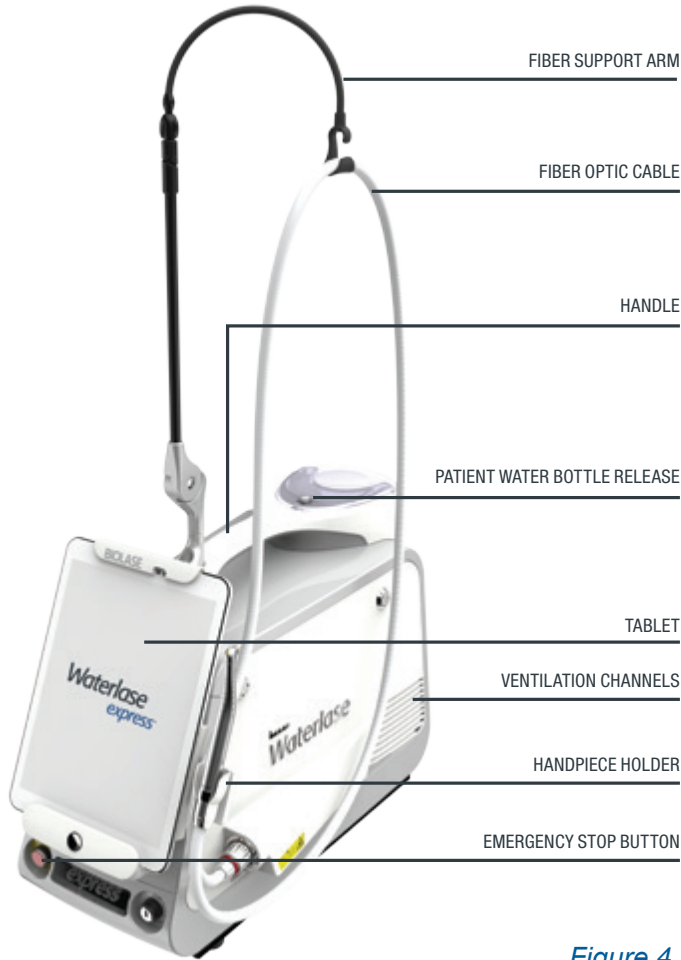

Figure 4

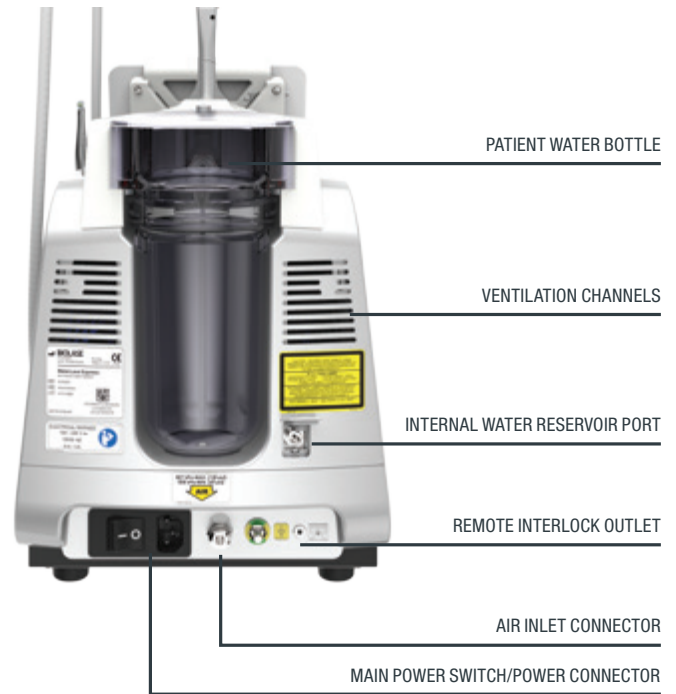

Figure 5

DAILY START-UP

1. Make sure the power cord is plugged in, the air line properly secured to the air inlet connector, and the remote interlock plug inserted in the remote interlock outlet, whether or not the Remote Interlock feature is used; if the plug is not in place, the laser system will not turn on.
2. Install the Tablet; press the power switch on the right side of the Tablet to turn it on [Figure 1-2]. Attach the protective cover to the Tablet, secure it around the latch, and drape the bottom over the Control Panel.
3. Insert the Fiber Optic Cable into the laser aperture, making sure the red dot above the pins is aligned with the red dot on the laser aperture; push the connector in without twisting until it is fully engaged, then turn the locknut clockwise to fix it snugly in place.
4. Carefully insert the Handpiece onto the fiber shaft without twisting until it sits firmly against the connector and clicks into place.



Figure 6



Figure 7

5. Check the patient water bottle is more than 1/3 full; add distilled or de-ionized water, as needed; **DO NOT use tap or filtered water.**
6. Turn the main power switch at the back of the console ON (I); when the power switch is OFF, the LEDs on the tablet holder will not light up. Make sure the tablet is fully turned on (the logo screen appears) before inserting the key into the Keyswitch and rotating it clockwise to the ON (I) position. The system will power up and the system software will begin to load (approximately 30 seconds).



Figure 8

CAUTION: Turning the key to the ON (I) position before the tablet has fully started up may cause a communication error. If an error does occur, first turn the keyswitch OFF (O) and power off the tablet; next, power on the tablet, and repeat Step 6.

7. If multiple users are configured to the Waterlase Express laser system, select the proper account/user when prompted.
8. Prime the Handpiece if not already primed. The Handpiece must be primed during initial setup or water will not flow from the Handpiece during procedures.
9. When priming is completed, the Home (Procedure) screen will appear; the system will be in Standby mode.

Choose a procedure, select and install a tip, and place the laser in Ready mode by pressing the Function Control button on the Control Panel. The laser is now ready to fire when the Footswitch is pressed.

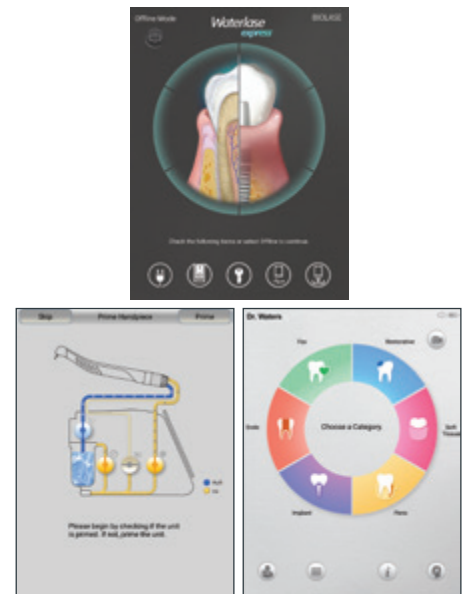

Figure 9

INSTALLING A TIP

1. Remove the Tip plug from the Handpiece head.
2. The Tip and handpiece must be sterilized before initial use and between patients as described in Section 11 of the Waterlase Express User Manual. If not sterilized in the Tip Holder, remove the Tip from its sterilization pouch and insert it into the Tip Holder by aligning the first groove of the Tip ferrule against the receiving edges of the Holder, then sliding the Tip in; using tweezers facilitates this process.
3. Align the Tip orifice of the Handpiece over the input end of the Tip placed in the Tip Holder.
4. Carefully lower the Handpiece and insert a clean/inspected Tip all the way until the shoulder of the Tip ferrule sits against the Handpiece head.
5. Slide the Handpiece laterally away from the Tip remover or Tip holder.



Figure 10

CAUTION: Never touch the proximal (input) end or distal (output) end of the Tip. If the proximal surface is contaminated, it may damage the Tip, Handpiece, and Fiber Optic Cable. Hold the tip only by the plastic ferrule. Be careful not to hit the proximal end of the Tip against the Handpiece head and not to break the retaining fingers of the plastic ferrule.

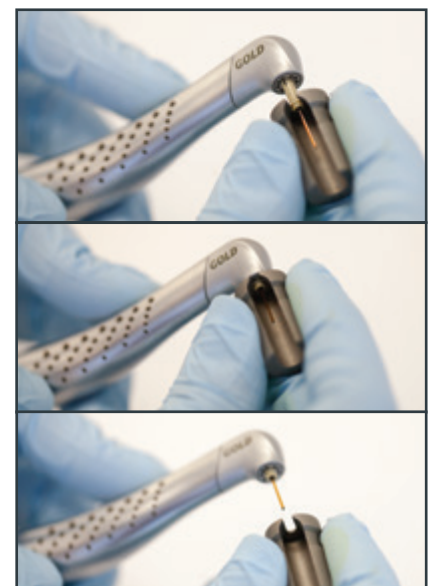

Figure 11

SLEEP MODE

The laser and Tablet will go into Sleep mode after 10 minutes of inactivity.

To “wake” the system, take the following steps:

1. Press the Function Control Button on the center of the Control Panel.
2. Press the power button on the side of the Tablet.

CAUTION: Make sure the Handpiece is stored in the Handpiece Holder whenever the laser system is powering up or waking from Sleep state.

END OF THE DAY

1. Press the logout icon at the bottom of the Home screen. [Figure 12]
2. Select “purge,” and wait for the process to complete.
3. Disconnect the Handpiece and Tip. Dispose of the Tip in a medical waste sharps container.
4. Turn the Keyswitch counterclockwise to the OFF (O) position.
5. Turn the power switch to the OFF (O) position.
6. Remove the Tablet protective cover and discard; if necessary, use a lightly pre-moistened lens cleaning wipe or equivalent to clean any residue or dirt from the Tablet. DO NOT use soap, water, chemicals containing ammonia, bleach, alcohol, or abrasive cleaners.
7. Wipe down the laser console using a standard disinfectant, such as Cavicide; DO NOT use bleach or abrasive cleaners.
8. Refer to your Waterlase Express User Manual, for detailed instruction on the cleaning and sterilization of the Handpiece and Tips.

TROUBLESHOOTING

Refer to Section 13 of the Waterlase Express User Manual. If you require further assistance please press the Customer Care button on the Waterlase Express display.

CAUTION: Press the Function Control button only once to change modes. The system will take approximately 1.5 seconds to respond when the button is pressed.

CAUTION: The wireless footswitch may be subject to interference from other wireless equipment, such as another Waterlase Express footswitch; if interference occurs, the laser may stop firing. To reactivate, stop pressing the footswitch, then press down and continue with the procedure.

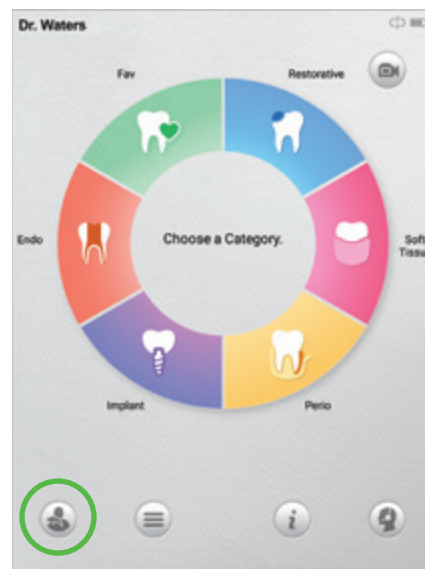

Figure 12

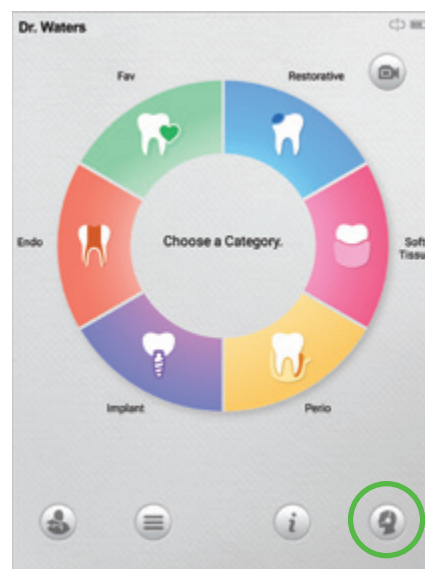

Figure 13

BIOLASE

biolase.com

Waterlase
express[™]



BIOLASE, INC.

4 Cromwell
Irvine, CA 92618 USA

Telephone: (888) 424-6527

Telephone: (949) 361-1200

Fax: (949) 273-6687

Service: (800) 321-6717



EU REPRESENTATIVE

MT Promedt Consulting GmbH

Altenhofstrasse 80

D-66386 St. Ingbert/Germany

+49 6894 581020

www.mt-procons.com

MADE IN THE USA

Copyright ©2016 BIOLASE, Inc. All rights reserved.

Waterlase Express[™] software copyright ©2016 BIOLASE, Inc.

EPIC, iLase, ezLase, ezTip, LaserWhite, Deep Tissue Handpiece, ComfortPulse, WaterLase, Waterlase Express and WaterLase iPlus are either trademarks or registered trademarks of BIOLASE, Incorporated in the United States and/or other countries. All other trademarks are property of their registered owners. Subject to change without notice.



5201547 REV. B 0482